

1830K LUCERNE

«Medium» version in the round flush recessed raking light range. Choice of lighting effects for customised LED marker-lighting.

APPLICATIONS:

- Decorative or safety marker-lighting
- Installed at regular intervals to mark a path, cycle path, stairs
- Public space enhancement

CARACTERISTICS

The flange hides recess plate imperfections.

- Anodised aluminium body
- Vandalproof organic glass window
- 316L Stainless steel screws
- Flush-recessed (except 1830K and 1830D)

- RGB options available

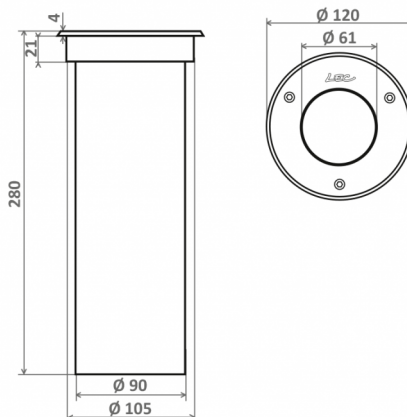

Number of LEDs	36, 12
Type of LEDs	120° SMD LEDs (S), SMD trichro (A)
Color(s)	Warm white 2700K (F), Warm white 3000K (E), Neutral white 4000K (N), Cool white 6000K (W), Red (R), Amber (O), Green (V), Blue (L), RVB (T)

Select your specific requirements with our product configurator, by filtering technical criteria at the following link:

<http://www.lec-lyon.com/1830kz-lucerne-r912>

APPLICATION

- Marker-lighting

CONFIGURATEUR.EMPLACEMENT

- Ground recessed fittings

CARACTERISTICS

Weight : 450 g

Options of luminous effects

- RGB options
- Adjustable on 1 axis
- Transparent flat window
- Colour control system (optional)

Power supply - Control

- Cable length: 1 m
- Integrated : 24V-PWM
- Remote : 24V-0/10V, 24V-DMX, 24V-DALI
- Integrated : 230V-Non dimmable

Material

- Anodised glazed aluminium
- 316L Stainless steel
- Vandalism-proof, scratch-proof, UV-proof, polycarbonate window, M2

Mechanical strength - Waterproofness

- Resists impacts up to IK10
- 60J
- Tight for extended immersion